

BASIC ADULT FABRIC FACE MASK

Better than a handkerchief, but doesn't provide high protection. Design based on written instructions by The Turban Project. Please check to make sure there is a need for your efforts/already a channel for donations.

- SUPPLIES**
- 100% Cotton Fabric (high threadcount, think "fine bedsheets")
 - Elastic: Rope elastic (ideal) or 1/8" flat elastic or beading cord elastic

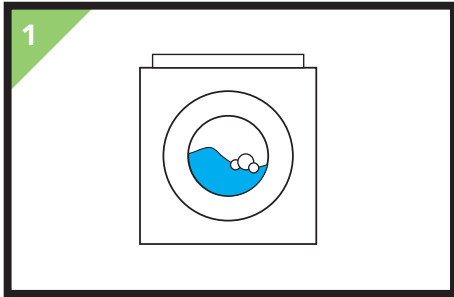

Wash cotton fabric in **hot water** and dry to preshrink before cutting. Iron if wrinkled.

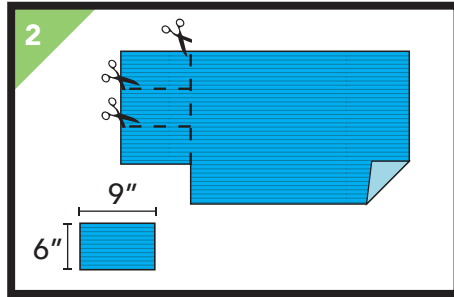

Cut fabric into 6"x9" rectangles.

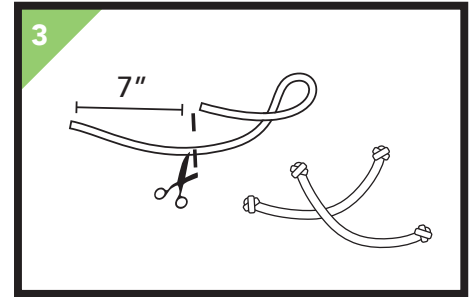

Cut the elastic into 7" lengths and knot ends.

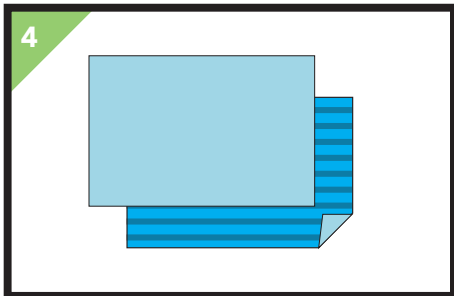

Align (2) pieces of fabric, right sides of fabric together.

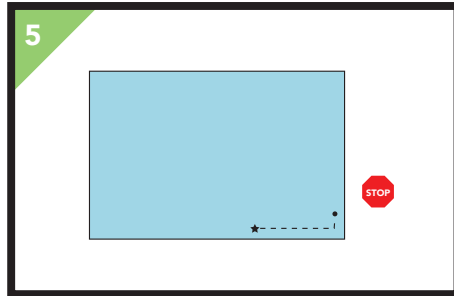

Begin to sew perimeter with 1/2" seam allowance, starting 2" from LR. Stop after turning corner.

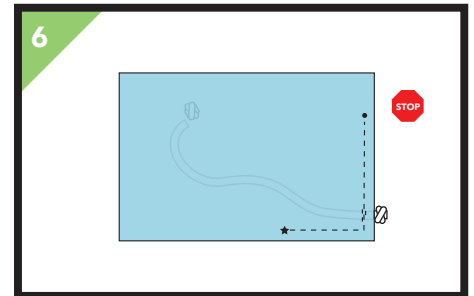

Slip elastic between layers, stitch and backstitch over elastic. Sew and stop 1" before edge.

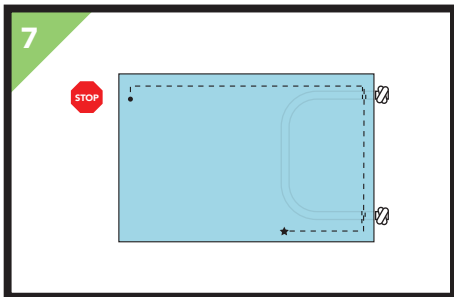

Expose the knot at the other end of elastic. Stitch/backstitch over, turn corner, sew to next corner, stop.

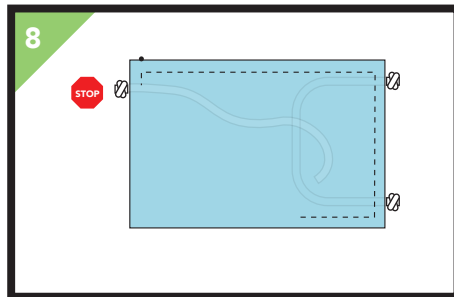

Insert the second elastic. Stitch/backstitch over elastic.

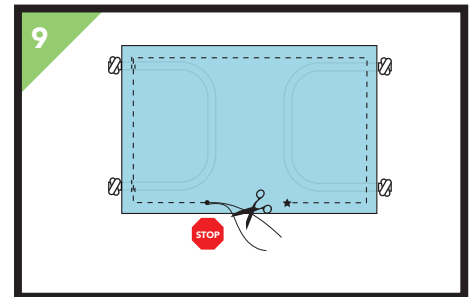

Continue sewing, mirroring the other side. Stop 2" from LL. Cut threads.

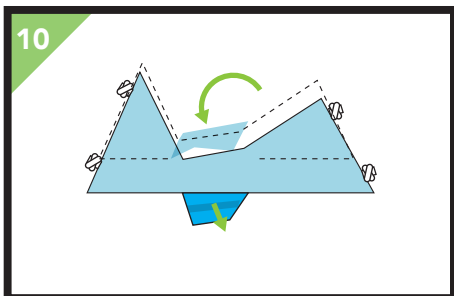

Turn inside out, press flat.

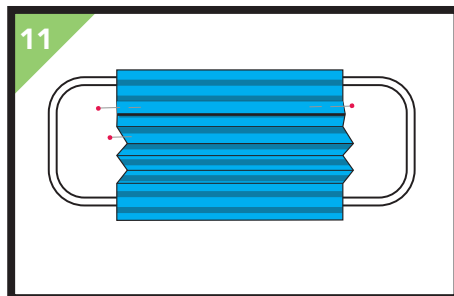

Fold and Pin (3) pleats on each side of the mask. Pleats should face same direction.

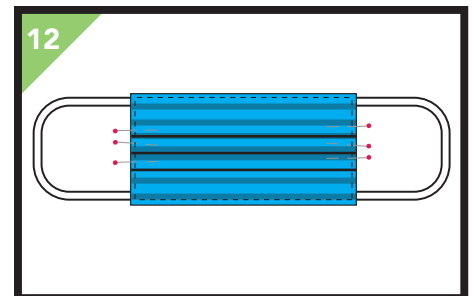

Sew around perimeter of mask twice, remove pins. **FINISHED!**